

SYM	PART NO.	PART NAME	QTY
	6114729M91	PIN W/ASSY	X
1	6114752M1	PIN FLAG	1
2	6114730M1	PIN	1

PŘEKŁAD
PROVEDLĀ
 dne: 28-02-2011
Prokory

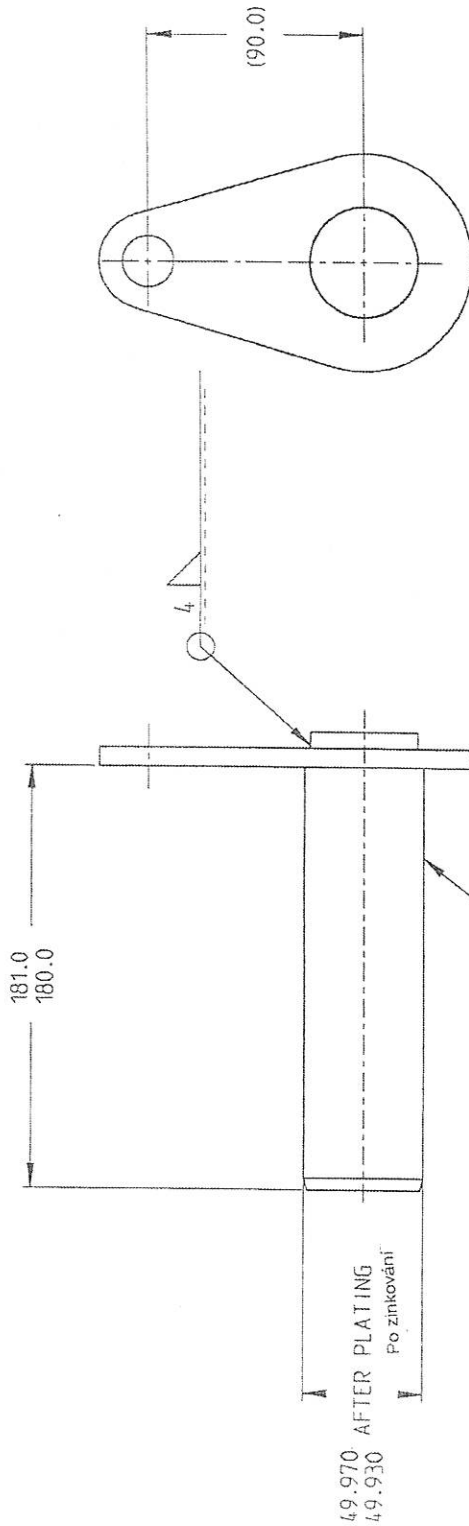

NAHRAZUJE ORIGINÁL

- Poznámky:
1. Svařovat v souladu s normou CPS 303
 2. Všechny plochy bez rozstřiku - kuliček
 3. Zinkovat podle CMS M1047 část 2 nebo zinkovat a odvodňovat podle CMS M1047 část 2
 4. Rozměry po zinkování

NOTES:

1. ARC WELDING TO BE IN ACCORDANCE WITH CPS 303.
2. ALL AREAS TO BE FREE FROM WELD SPATTER.
3. ZINC PLATE TO CMS M1047 PART 2 OR ZINC PLATE & HYDROGEN RELIEF ANNEAL TO CMS M1047 PART 2.
4. ALL DIMENSIONS AFTER PLATING.

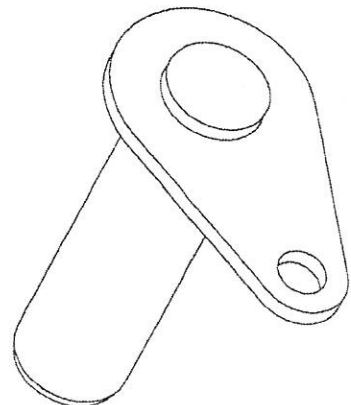

3D VIEW

PRODUCTION OF PARTS	DATE	BY	REV	DATE	BY
1	28-02-2011	PROKORY	1		
2			2		
3			3		
4			4		
5			5		
6			6		
7			7		
8			8		
9			9		
10			10		
11			11		
12			12		
13			13		
14			14		
15			15		
16			16		
17			17		
18			18		
19			19		
20			20		
21			21		
22			22		
23			23		
24			24		
25			25		
26			26		
27			27		
28			28		
29			29		
30			30		
31			31		
32			32		
33			33		
34			34		
35			35		
36			36		
37			37		
38			38		
39			39		
40			40		
41			41		
42			42		
43			43		
44			44		
45			45		
46			46		
47			47		
48			48		
49			49		
50			50		
51			51		
52			52		
53			53		
54			54		
55			55		
56			56		
57			57		
58			58		
59			59		
60			60		
61			61		
62			62		
63			63		
64			64		
65			65		
66			66		
67			67		
68			68		
69			69		
70			70		
71			71		
72			72		
73			73		
74			74		
75			75		
76			76		
77			77		
78			78		
79			79		
80			80		
81			81		
82			82		
83			83		
84			84		
85			85		
86			86		
87			87		
88			88		
89			89		
90			90		
91			91		
92			92		
93			93		
94			94		
95			95		
96			96		
97			97		
98			98		
99			99		
100			100		

PRODUCTION OF PARTS	DATE	BY	REV	DATE	BY
1	28-02-2011	PROKORY	1		
2			2		
3			3		
4			4		
5			5		
6			6		
7			7		
8			8		
9			9		
10			10		
11			11		
12			12		
13			13		
14			14		
15			15		
16			16		
17			17		
18			18		
19			19		
20			20		
21			21		
22			22		
23			23		
24			24		
25			25		
26			26		
27			27		
28			28		
29			29		
30			30		
31			31		
32			32		
33			33		
34			34		
35			35		
36			36		
37			37		
38			38		
39			39		
40			40		
41			41		
42			42		
43			43		
44			44		
45			45		
46			46		
47			47		
48			48		
49			49		
50			50		
51			51		
52			52		
53			53		
54			54		
55			55		
56			56		
57			57		
58			58		
59			59		
60			60		
61			61		
62			62		
63			63		
64			64		
65			65		
66			66		
67			67		
68			68		
69			69		
70			70		
71			71		
72			72		
73			73		
74			74		
75			75		
76			76		
77			77		
78			78		
79			79		
80			80		
81			81		
82			82		
83			83		
84			84		
85			85		
86			86		
87			87		
88			88		
89			89		
90			90		
91			91		
92			92		
93			93		
94			94		
95			95		
96			96		
97			97		
98			98		
99			99		
100			100		

28. pros 2010

260 093 432 000 07

7/1/2

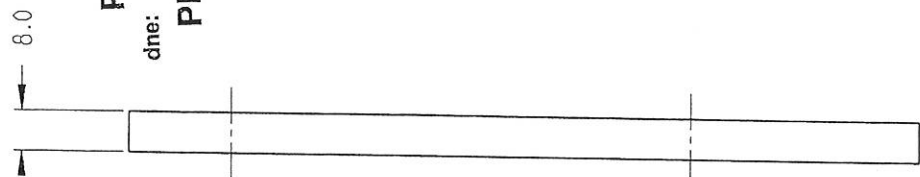

NAHRAZUJE ORIGINAL

	THIRD ANGLE PROJECTION	DRAWING P-LOCKERS-8	DATE 03-10-08
			DATE
		COVENTRY	
INFLAMMABLE		PIN FLAG	
		DATE	
		1	
PART NO.		61144152M1	

21. pros. 2009

TYPICAL USES OR DIMENSIONS (UNLESS OTHERWISE SPECIFIED)		SCALE		SHEET		MATERIAL																			
<table border="1"> <tr> <td>MINORAL SIZE OF DIMENSION</td> <td>mm</td> <td>OTHER</td> <td>1:50</td> <td>1:10</td> <td>1:500</td> </tr> <tr> <td>0 OR 1 DECIMAL PLACE</td> <td>—</td> <td>YES</td> <td>1:50</td> <td>1:10</td> <td>1:500</td> </tr> <tr> <td>2 DECIMAL PLACE</td> <td>—</td> <td>±0.5</td> <td>±1.0</td> <td>±5</td> <td>±5</td> </tr> </table>		MINORAL SIZE OF DIMENSION	mm	OTHER	1:50	1:10	1:500	0 OR 1 DECIMAL PLACE	—	YES	1:50	1:10	1:500	2 DECIMAL PLACE	—	±0.5	±1.0	±5	±5	1:1		1 OF 1		STEEL TO BS EN 10025 S355 JR	
MINORAL SIZE OF DIMENSION	mm	OTHER	1:50	1:10	1:500																				
0 OR 1 DECIMAL PLACE	—	YES	1:50	1:10	1:500																				
2 DECIMAL PLACE	—	±0.5	±1.0	±5	±5																				
ANNUAL TOLERANCE		0.5 kg		A3		PAINT																			
DIMENSIONS IN MILLIMETRES (UNLESS OTHERWISE SPECIFIED)		0.5 kg		A3		TYPICAL DIMENSIONS																			

REMOVE ALL BURRS & SHARP EDGES
ДОВЕРНИТЬ ВСЕДННУЮ ОТРЕПЬ А ОСТРЕ' ДВАНУ

1	2	3
---	---	---

- 8. p. 805. 2010

8/14

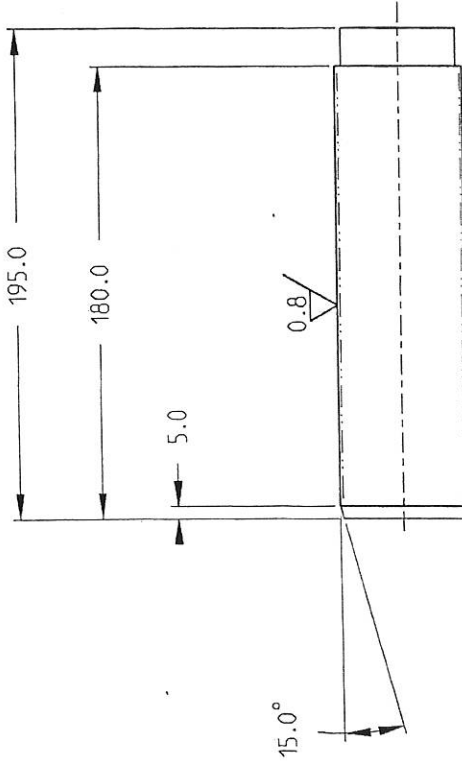

HEAT TREATMENT ZONE
Tepelně zpracovaná plocha

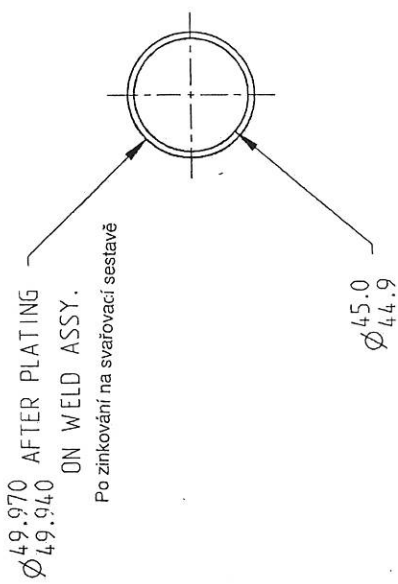

$\phi_{49.970}$ AFTER PLATING
 $\phi_{49.940}$ ON WELD ASSY.
Po zinkování na svařovací sestavě

PŘEKLAD
 dne: 28-02-2011
PROVEDLÍ
 Božena m

12.5 (✓)
4/4

- Poznámky:**
- Indukčně kalit do 1,6 až 2,3 efektivní hloubky. Tvrdost povrchu HRC 54-60. Mechanické vlastnosti jádra musí splňovat požadavky podle BS970 „T“.
 - Všechny uvedené rozměry po zinkování
 - Indukčně kalená zóna bez feritu.
 - Alternativní materiál – EN 10083 42CrMo4 (obsah uhlíku 0,4-0,45)

NOTES:

- INDUCTION HARDEN 1.6 TO 2.3 EFFECTIVE DEPTH. TEMPER SURFACE TO ROCKWELL “C” 54-60. CORE MECHANICAL PROPERTIES TO COMPLY WITH BS970 “T” REQUIREMENTS.
- ALL DIMENSIONS SHOWN AFTER PLATING.
- INDUCTION HARDENED ZONE TO BE FREE OF FERRITE.
- ALTERNATIVE MATERIAL – EN 10083 42CRM04 (CARBON 0.4-0.45) CARBON RESTRICTED SPECIFICATION.

NAHAZUJE ORIGINAL

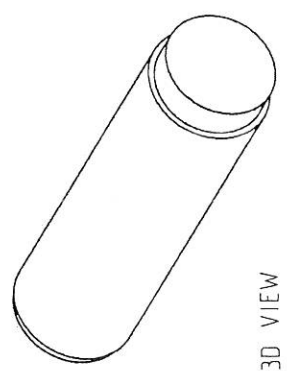

3D VIEW

TOTAL NUMBER OF DIMENSIONS AND LINE IDENTIFICATION SPECIFIED				SCALE				SHEET		MATERIAL	
NO.	TYPE	UNIT	VALUE	NO.	TYPE	UNIT	VALUE	1 OF 1	1:2	STEEL TO	BS 970 70S M40T
1	ON THERMAL PLATE	mm	195.0	2	ON THERMAL PLATE	mm	180.0				
2	ON THERMAL PLATE	mm	5.0	3	ON THERMAL PLATE	mm	4.4.9				
3	ON THERMAL PLATE	mm	15.0	4	ON THERMAL PLATE	mm	0.8				
5	ON THERMAL PLATE	mm	4.4.9	6	ON THERMAL PLATE	mm	4.4.9				
7	ON THERMAL PLATE	mm	4.4.9	8	ON THERMAL PLATE	mm	4.4.9				
9	ON THERMAL PLATE	mm	4.4.9	10	ON THERMAL PLATE	mm	4.4.9				
11	ON THERMAL PLATE	mm	4.4.9	12	ON THERMAL PLATE	mm	4.4.9				
13	ON THERMAL PLATE	mm	4.4.9	14	ON THERMAL PLATE	mm	4.4.9				
15	ON THERMAL PLATE	mm	4.4.9	16	ON THERMAL PLATE	mm	4.4.9				
17	ON THERMAL PLATE	mm	4.4.9	18	ON THERMAL PLATE	mm	4.4.9				
19	ON THERMAL PLATE	mm	4.4.9	20	ON THERMAL PLATE	mm	4.4.9				
21	ON THERMAL PLATE	mm	4.4.9	22	ON THERMAL PLATE	mm	4.4.9				
23	ON THERMAL PLATE	mm	4.4.9	24	ON THERMAL PLATE	mm	4.4.9				
25	ON THERMAL PLATE	mm	4.4.9	26	ON THERMAL PLATE	mm	4.4.9				
27	ON THERMAL PLATE	mm	4.4.9	28	ON THERMAL PLATE	mm	4.4.9				
29	ON THERMAL PLATE	mm	4.4.9	30	ON THERMAL PLATE	mm	4.4.9				
31	ON THERMAL PLATE	mm	4.4.9	32	ON THERMAL PLATE	mm	4.4.9				
33	ON THERMAL PLATE	mm	4.4.9	34	ON THERMAL PLATE	mm	4.4.9				
35	ON THERMAL PLATE	mm	4.4.9	36	ON THERMAL PLATE	mm	4.4.9				
37	ON THERMAL PLATE	mm	4.4.9	38	ON THERMAL PLATE	mm	4.4.9				
39	ON THERMAL PLATE	mm	4.4.9	40	ON THERMAL PLATE	mm	4.4.9				
41	ON THERMAL PLATE	mm	4.4.9	42	ON THERMAL PLATE	mm	4.4.9				
43	ON THERMAL PLATE	mm	4.4.9	44	ON THERMAL PLATE	mm	4.4.9				
45	ON THERMAL PLATE	mm	4.4.9	46	ON THERMAL PLATE	mm	4.4.9				
47	ON THERMAL PLATE	mm	4.4.9	48	ON THERMAL PLATE	mm	4.4.9				
49	ON THERMAL PLATE	mm	4.4.9	50	ON THERMAL PLATE	mm	4.4.9				
51	ON THERMAL PLATE	mm	4.4.9	52	ON THERMAL PLATE	mm	4.4.9				
53	ON THERMAL PLATE	mm	4.4.9	54	ON THERMAL PLATE	mm	4.4.9				
55	ON THERMAL PLATE	mm	4.4.9	56	ON THERMAL PLATE	mm	4.4.9				
57	ON THERMAL PLATE	mm	4.4.9	58	ON THERMAL PLATE	mm	4.4.9				
59	ON THERMAL PLATE	mm	4.4.9	60	ON THERMAL PLATE	mm	4.4.9				
61	ON THERMAL PLATE	mm	4.4.9	62	ON THERMAL PLATE	mm	4.4.9				
63	ON THERMAL PLATE	mm	4.4.9	64	ON THERMAL PLATE	mm	4.4.9				
65	ON THERMAL PLATE	mm	4.4.9	66	ON THERMAL PLATE	mm	4.4.9				
67	ON THERMAL PLATE	mm	4.4.9	68	ON THERMAL PLATE	mm	4.4.9				
69	ON THERMAL PLATE	mm	4.4.9	70	ON THERMAL PLATE	mm	4.4.9				
71	ON THERMAL PLATE	mm	4.4.9	72	ON THERMAL PLATE	mm	4.4.9				
73	ON THERMAL PLATE	mm	4.4.9	74	ON THERMAL PLATE	mm	4.4.9				
75	ON THERMAL PLATE	mm	4.4.9	76	ON THERMAL PLATE	mm	4.4.9				
77	ON THERMAL PLATE	mm	4.4.9	78	ON THERMAL PLATE	mm	4.4.9				
79	ON THERMAL PLATE	mm	4.4.9	80	ON THERMAL PLATE	mm	4.4.9				
81	ON THERMAL PLATE	mm	4.4.9	82	ON THERMAL PLATE	mm	4.4.9				
83	ON THERMAL PLATE	mm	4.4.9	84	ON THERMAL PLATE	mm	4.4.9				
85	ON THERMAL PLATE	mm	4.4.9	86	ON THERMAL PLATE	mm	4.4.9				
87	ON THERMAL PLATE	mm	4.4.9	88	ON THERMAL PLATE	mm	4.4.9				
89	ON THERMAL PLATE	mm	4.4.9	90	ON THERMAL PLATE	mm	4.4.9				
91	ON THERMAL PLATE	mm	4.4.9	92	ON THERMAL PLATE	mm	4.4.9				
93	ON THERMAL PLATE	mm	4.4.9	94	ON THERMAL PLATE	mm	4.4.9				
95	ON THERMAL PLATE	mm	4.4.9	96	ON THERMAL PLATE	mm	4.4.9				
97	ON THERMAL PLATE	mm	4.4.9	98	ON THERMAL PLATE	mm	4.4.9				
99	ON THERMAL PLATE	mm	4.4.9	100	ON THERMAL PLATE	mm	4.4.9				

21. pros. 2009

DESIGNER	DATE
6114730M1	22-05-08
APPROVED	DATE
6114730M1	22-05-08
CHECKED	DATE
6114730M1	22-05-08
CONVENTY	DATE
6114730M1	22-05-08

8. pros. 2010

97/18